

Merry Fisher

795 Série 2

Merry Fisher 795 Série 2 - 07/2024

SUMMARY

- SPECIFICATIONS
- KEY POINTS
- EXTERIOR
- INTERIOR
- ATMOSPHERES
- ELECTRONIC PACKAGES
- TECHNICAL DATAS



JEANNEAU

Injected hull



MAIN SPECIFICATIONS

Overall length :		Engine shaft length.....	XL (635mm)
without options	7,19 m / 23'7"	Fuel capacity	280 L / 74,0 US gal
with options	8,14 m / 26'8"	Water capacity	100 L / 26,4 US gal
Hull length	6,97 m / 22'10"	Berths	4
Overall beam	2,82 m / 9'3"	Cabin	1
Draft	0,58 m / 1'10"
Air draft	2,31 m / 7'6"	EC category	C - 9
Weight without engine (approximatly)	2153 kg / 4747 lbs	Designers	Jeanneau Design /
Max engine power	250 HP / 184 kw	Centkowski & Denert Design

A NEW DESIGN AND UNEQUALLED COMFORT

Now even better, this new MERRY FISHER is an elegant new weekender with a new hull for ultra-high performance and versatility.

Exceptionally comfortable to drive, delivering a high-level performance and surprising stability under way, these are among the many qualities of this future best seller with its distinctive design.

Already a solid performer when equipped with mid-range engine power, the Merry Fisher 795 Series 2 enters a new category with its maximum power of 250 HP.

EXTERIOR

Perfectly suited to coastal cruising with family, the U-shaped cockpit saloon is inviting, spacious and modular.

Open to the sea, it invites swimming and relaxation.

Particularly modular, the bench seating adapts to the rhythm of life on board. The aft bench seating slides forward to reveal the engine and the portside bench seating can be folded away.

A very large aft sundeck is created by using the table as support, for moments of complete relaxation.

These innovations enable us to obtain more space for storage of one, or even two portable coolers.

The new side door (as on the Merry Fisher 895 and 1095) facilitates access on board.

INTERIOR

On the interior, the living space is even brighter and more comfortable. It is also more spacious for even greater comfort on board.

The Merry Fisher 795 Series 2 offers a surprising breadth of functionality and equipment for its size category.

The saloon with facing seating features a Jeanneau co-pilot bench seat and a very generous storage volume.

The galley, with its particularly well integrated countertop finish, features two sinks and can be fully equipped with additional options

MORE COMFORT

The cabin space is also equipped with an enclosed head compartment and hot-water shower.

Particular attention has been paid to optimising the natural ventilation. Air vents above the windscreen enable fresh air to be pushed into the interior at cruising speed.

A high-performance reversible air conditioning unit can operate from the battery banks, providing three to four hours of autonomy (at port, the air conditioning operates on shore power while the batteries recharge).

Another strong point, the Merry Fisher 795 Series 2 features a paddleboard storage space

ELEGANT AND FAMILY FRIENDLY BOAT WITH A REWARDING STYLE

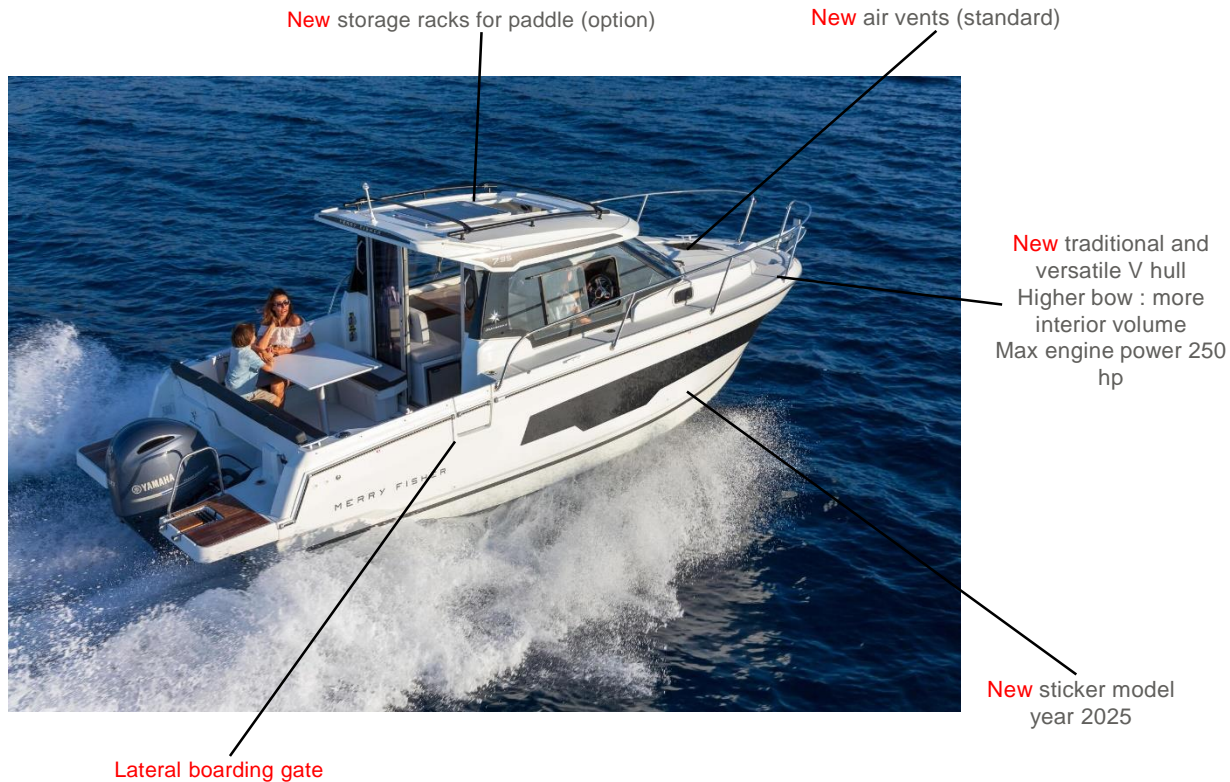

EASY ACCESS ON BOARD



Easy access to the cockpit :
Big « flush » swim platforms with
handrail and recessed ladder

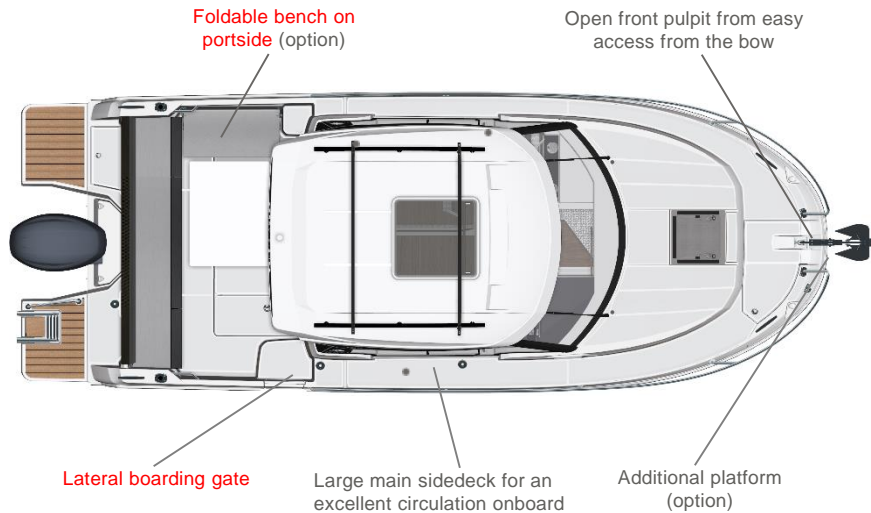

EASY ACCESS ON BOARD



New lateral boarding gate (standard)

Modular cockpit



New Foldable bench on portside (option)

Aft sliding bench with long clearance :

- It enables to expand exterior and interior spaces while the engine is down
- It enables to lift the engine up
- The aft bench remains available when the engine is up

Can be slided with one hand

Modular cockpit



Standard : aft bench with removable corner seats (fishing)



Option : foldable bench on portside



Option : U cockpit saloon with a table, convertible into a sunpad





Standard : Handrails on the roof



Option : **New** storage racks for paddle



Large and bright interior : the windows are going down to the table



Standard galley :

2 sinks, compatible with a portative gas stove



Option Luxury Galley :

Black worktop with stove + gas box + sink

Fridge (option) is under the saloon seat

Enables a double storage in the galley





New large storage under the saloon : it enables to store the exterior upholstery



Four people saloon



Saloon convertible in a double berth using the table as support (option)



Copilot bench : **very easy** to transform into saloon bench by simply tilting the backrest



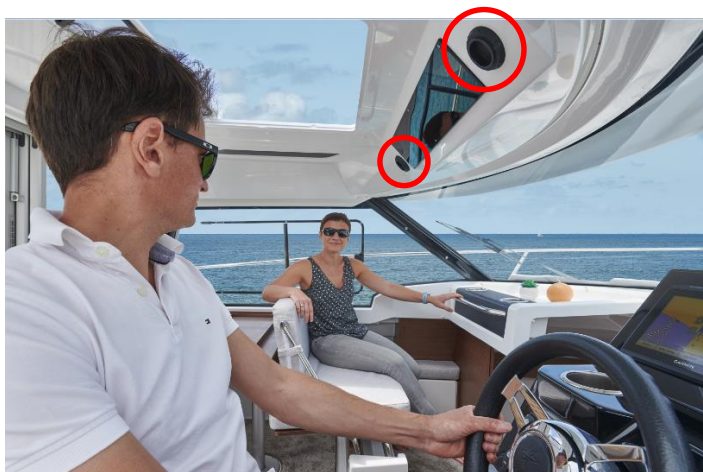

New air vents above the windshield (standard)

- Better ventilation onboard in summer
- The air is pushed inside when motoring at cruising speed

1 8000 BTU air conditioning

 Cold air exits

2 Enclosed toilet compartment with sink
+
seated shower with water heater



3 Easy access to the battery switches

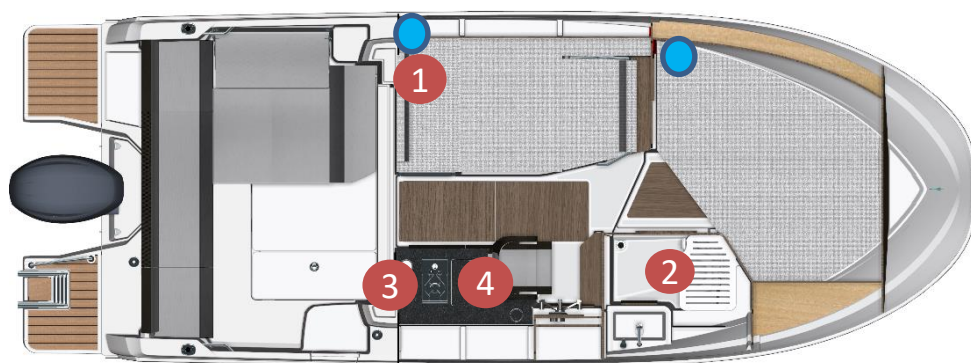

4 Water heater located under the galley storage



New option seated
shower with water heater



Storage shelves on both sides



Storages under the bed



Bow thruster (option)



Option : Cockpit sun awning

Option : Cockpit aft closure kit
(requires cockpit sun awning option)

Design : Jeanneau - Vavaruste

MERRY FISHER

EXTÉRIEUR / EXTERIOR

SELLERIE /
UPHOLSTERY

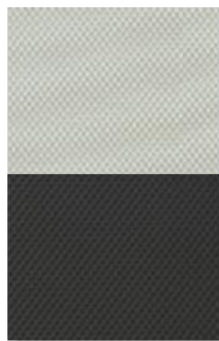

DIAMANTE
MOONLIGHT /
DIAMANTE
CARBON

CAPOTAGES /
AWNINGS



SUNBRELLA
GRAPHITE

PROTECTIONS /
COVERS

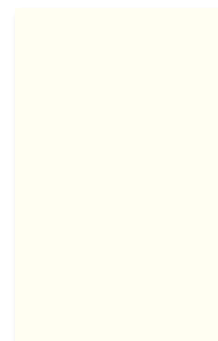

PVC
STAMOID
WHITE

MERRY FISHER

INTÉRIEUR / INTERIOR

SELLERIE /
UPHOLSTERY



JUMBO
SILVER

MENUISERIES (Standard) /
WOOD

MEUBLES /
FURNITURES
GREY WALNUT

FLOORBOARD
iPLANCHERS
BROWN OAK



ELECTRONIC PACK

ECHOMAP UHD2 92sv
Chartplotter/Sonar combo with 9"
keyed-assist touchscreen display.



Garmin GT23M-TM
Mid-Band CHIRP Traditional /
CHIRP ClearVü
Depth and Temperature

UPGRADE

1 GPSMAP i223xsv (12") INSTEAD OF AN ECHOMAP UHD2 92sv (9")

GPSMAP i223xsv
MFD with multitouch 12" screen



OPTION

FIXED-MOUNT VHF RADIO

VHF 215i AIS
VHF radio with integrated AIS receiver
(1W / 25W)



RÉGIMES - VITESSES - CONSOMMATION / RPM - SPEED - CONSUMPTION

Bateaux / Boats	Moteur / Engine	Hélice / Propeller(s)	Charge / Loading (kg)	Régime maxi (T/mn) / Max Rpm	Vitesse maxi (nœuds) / Max speed (knots)	Conso* (L/h) / Conso** (L/h)	Régime croisière (T/mn) / Cruising Rpm	Vitesse croisière (nœuds) / Cruising speed (knots)	Conso* (L/h) / Conso** (L/h)
Merry Fisher 605 Serie²	YAMAHA F100 LB	K12 TALON	2122 Kg	5800	24,1	38,9	5000	19,3	35,1
	YAMAHA F115 LB	K12 TALON	2122 Kg	6300	26,3	41,9	5000	19,1	25,7
Merry Fisher 695 Serie²	YAMAHA F115 LB	K12 TALON ALU	2042 Kg	5800	23,5	62,1	5000	18,4	42,6
	YAMAHA F150 LB	M14 Reliance	2111 Kg	5800	31,2	62,1	4500	21,5	34,1
	YAMAHA F175 LCA	M14 Reliance	2147 Kg	5800	33,4	64,7	4500	24,5	34,4
Merry Fisher 795	YAMAHA F150 XB	M13 Reliance	3371 Kg	5700	26,3	58,2	5000	21,2	42,1
	YAMAHA F200 XCA	M13 Reliance	3364 Kg	5900	29,6	75,1	4500	20,1	38,4
	YAMAHA F225 XCB	T13 SALTWATER	3422 Kg	5700	32,5	85,2	4500	25,0	53,1
	YAMAHA F250 XCB	T15 SALTWATER	3422 Kg	5600	34,3	97,0	4500	27,1	65,4
	YAMAHA F250 XCB	T13 SALTWATER	3722 Kg	5800	33,2	94,0	4500	24,3	54,2
Merry Fisher 895	YAMAHA 300 BETU	T13 SWSDS	4618 Kg	6000	29,3	101,5	5000	21,3	75,5
	YAMAHA 2 x F & LF 150 XCA	M14 Reliance	5050 Kg	6000	32,2	111,3	4500	20,4	61,6
Merry Fisher 895 Offshore	YAMAHA 2 x F & LF 200 XCA	M15 Reliance SDS	5014 Kg	6000	36,8	149,1	4500	21,2	59,1
Merry Fisher 1095	YAMAHA 2 x F & LF 300 UCB	T15 SALTWATER	7446 Kg	6000	37,6	205,0	4000	23,3	93,8
Merry Fisher 1095 Fly	YAMAHA 2 x F & LF 300 UCB	T15 SALTWATER	8609 Kg	5900	36,2	200,7	4500	25,3	115,7
Merry Fisher 695 Sport Serie²	YAMAHA F115 LB	K12 TALON ALU	2140 Kg	6000	22,7	42,1	5000	15,4	26,8
	YAMAHA F150 LCA	M14 Reliance	2133 Kg	5800	30,3	61,2	4500	20,6	33,6
	YAMAHA F175 LCA	M14 Reliance	2222 Kg	5800	31,9	66,2	4500	23,0	36,4
Merry Fisher 795 Sport Serie²	YAMAHA F200 XCA	T13 Reliance	3380 Kg	5800	30,1	74,4	4500	18,2	38,7
	YAMAHA F225 XCB	T13 SALTWATER	3441 Kg	5700	31,7	82,6	4500	24,5	53,7
	YAMAHA F250 XCB	T13 SALTWATER	3516 Kg	5800	34	93,3	4500	22,25	52,4
Merry Fisher 895 Sport	YAMAHA 2 x F et LF 175 XCA	RH/LH 14 RELIANCE	5769 Kg	6000	34,4	129	4500	23,9	68,1
Merry Fisher 895 Sport Offshore	YAMAHA 2 x F & LF 200 XCA	RH/LH 15 RELIANCE	5679 Kg	6000	37,9	152,2	4500	25,7	79,8
	YAMAHA 2 x F & LF 225 XCB	RH/LH 15 SALTWATER	5814 Kg	6000	40,0	175,8	4000	25,8	85,6
	YAMAHA 2 x F & LF 250 XCB	Saltwater T17 & TL17	5233 Kg	6000	43,2	196,2	4000	30,1	87,9

Essai dans les conditions optimum (carène propre, sans antifouling, bateau-lège...) / Trials in the optimum conditions (clean hull, no antifouling, light displacement)

* Consommation totale du bateau / Total consumption of the boat ** Test fait avec une ancienne référence d'hélice / test done with an old propeller reference

*** Ce montage nécessite l'installation sur le tableau arrière d'un bracket disponible en option / This installation requires the optional mounting bracket on transom • ND = Non Disponible / No Data.

Ces informations sont données à titre indicatif et peuvent varier selon les conditions d'utilisation, de charge etc... / These average datas are given for guidance and may vary according to sailing conditions, loading etc...

RÉGIMES - VITESSES - CONSOMMATION / RPM - SPEED - CONSUMPTION

Merry Fisher 795 serie 2							
		YAMAHA 150cv					
		<u>Caractéristique / Specifications:</u>					
		2 moteur Hors Bord / Out Board engines: F 150GETX /XCA					
		Hélice / Propeller: M13 RELIANCE					
Déplacement total du bateau / Total displacement of boat tested: 3371 Kg							
Regime en tours par minute au tableau de bord / RPM on instrument panel	Vitesse en nœuds moyenne au gps / Average speed on gps in knots	Consommation moteur en litres par heure / consumption engine in liter an hour	Rendement / Efficiency (L/NM = Liter per Nautical Mile)	Consommation totale en USGal / heure Total consumption in USGal/h	Rendement / Efficiency (USGal/NM)	Autonomie en miles nautiques (avec réserve 20%) /Range in Nautical Miles (with 20% fuel safety)	Remarques / Comments
600	2,1 Nds	1,9 l/h	,93 L/NM	,50 USGal/h	,24 USGal/NM	183 NM	
1000	3,3 Nds	3,2 l/h	,97 L/NM	,85 USGal/h	,26 USGal/NM	175 NM	
1500	4,8 Nds	4,9 l/h	1,03 L/NM	1,29 USGal/h	,27 USGal/NM	165 NM	
2000	6,2 Nds	7,4 l/h	1,20 L/NM	1,95 USGal/h	,32 USGal/NM	141 NM	
2500	7,2 Nds	9,9 l/h	1,38 L/NM	2,62 USGal/h	,37 USGal/NM	123 NM	
3000	8,1 Nds	14,3 l/h	1,78 L/NM	3,78 USGal/h	,47 USGal/NM	96 NM	
3500	9,1 Nds	20,4 l/h	2,24 L/NM	5,39 USGal/h	,59 USGal/NM	76 NM	
4000	11,0 Nds	26,1 l/h	2,37 L/NM	6,89 USGal/h	,63 USGal/NM	72 NM	
4500	13,5 Nds	32,5 l/h	2,41 L/NM	8,59 USGal/h	,64 USGal/NM	71 NM	
5000	21,2 Nds	42,1 l/h	1,99 L/NM	11,12 USGal/h	,52 USGal/NM	86 NM	
5500	23,6 Nds	51,6 l/h	2,19 L/NM	13,63 USGal/h	,58 USGal/NM	78 NM	
6000	26,3 Nds	58,2 l/h	2,22 L/NM	15,37 USGal/h	,59 USGal/NM	77 NM	
<u>Conditions optimales théoriques et purement indicatives des essais: /Optimal theoretical conditions, purely indicative for trials :</u>							
Coque neuve, vent 5nds, mer belle petit clapot, pas d'antifouling / new hull, wind 5 knots, nice little choppy sea, no antifouling							
08/06/2020							

RÉGIMES - VITESSES - CONSOMMATION / RPM - SPEED - CONSUMPTION

Merry Fisher 795 serie 2							
		YAMAHA 200cv					
		Caractéristique / Specifications:					
		moteur Hors Bord / Out Board engine:				F 200GETX / XCA	
		Hélice / Propeller:				M13 Reliance	
Déplacement total du bateau / Total displacement of boat tested: 3364 Kg							
Regime en tours par minute au tableau de bord / RPM on instrument panel	Vitesse en nœuds moyenne au gps / Average speed on gps in knots	Consommation moteur en litres par heure / consumption engine in liter an hour	Rendement / Efficiency (L/NM = Liter per Nautical Mile)	Consommation totale en USGal / heure Total consumption in USGal/h	Rendement / Efficiency (USGal/NM)	Autonomie en miles nautiques (avec réserve 20%) /Range in Nautical Miles (with 20% fuel safety)	Remarques / Comments
600	2,0 Nds	1,6 l/h	,80 L/NM	,42 USGal/h	,21 USGal/NM	356 NM	
1000	3,4 Nds	3,0 l/h	,90 L/NM	,79 USGal/h	,24 USGal/NM	318 NM	
1500	4,7 Nds	4,7 l/h	1,00 L/NM	1,24 USGal/h	,26 USGal/NM	285 NM	
2000	5,9 Nds	6,9 l/h	1,18 L/NM	1,82 USGal/h	,31 USGal/NM	242 NM	
2500	7,2 Nds	11,8 l/h	1,65 L/NM	3,12 USGal/h	,44 USGal/NM	173 NM	
3000	8,0 Nds	15,7 l/h	1,96 L/NM	4,15 USGal/h	,52 USGal/NM	145 NM	
3500	9,7 Nds	23,3 l/h	2,41 L/NM	6,16 USGal/h	,64 USGal/NM	118 NM	
4000	12,3 Nds	30,4 l/h	2,48 L/NM	8,03 USGal/h	,66 USGal/NM	115 NM	
4500	20,1 Nds	38,4 l/h	1,92 L/NM	10,14 USGal/h	,51 USGal/NM	149 NM	
5000	23,4 Nds	50,8 l/h	2,18 L/NM	13,42 USGal/h	,57 USGal/NM	131 NM	
5500	27,1 Nds	64,5 l/h	2,38 L/NM	17,04 USGal/h	,63 USGal/NM	120 NM	
5700	29,6 Nds	75,1 l/h	2,54 L/NM	19,84 USGal/h	,67 USGal/NM	112 NM	
<u>Conditions optimales théoriques et purement indicatives des essais: /Optimal theoretical conditions, purely indicative for trials :</u> Coque neuve, vent 5nds, mer belle petit clapot, pas d'antifouling / new hull, wind 5 knots, nice little choppy sea, no antifouling							
09/06/2020							

RÉGIMES - VITESSES - CONSOMMATION / RPM - SPEED - CONSUMPTION

Merry Fisher 795 serie 2							
		YAMAHA 250cv					
		<u>Caractéristique / Specifications:</u>					
		2 moteur Hors Bord / Out Board engines: F 250DETX / XCB DBW					
		Hélice / Propeller: T13 SALTWATER					
Déplacement total du bateau / Total displacement of boat tested: 3722 Kg							
Regime en tours par minute au tableau de bord / RPM on instrument panel	Vitesse en nœuds moyenne au gps / Average speed on gps in knots	Consommation moteur en litres par heure / consumption engine in liter an hour	Rendement / Efficiency (L/NM = Liter per Nautical Mile)	Consommation totale en USGal / heure Total consumption in USGal/h	Rendement / Efficiency (USGal/NM)	Autonomie en miles nautiques (avec réserve 20%) /Range in Nautical Miles (with 20% fuel safety)	Remarques / Comments
600	2,4 Nds	2,1 l/h	,89 L/NM	,55 USGal/h	,24 USGal/NM	319 NM	
1000	3,7 Nds	4,5 l/h	1,22 L/NM	1,19 USGal/h	,32 USGal/NM	234 NM	
1500	5,6 Nds	7,7 l/h	1,39 L/NM	2,03 USGal/h	,37 USGal/NM	205 NM	
2000	6,8 Nds	11,7 l/h	1,72 L/NM	3,09 USGal/h	,45 USGal/NM	166 NM	
2500	7,8 Nds	19,2 l/h	2,48 L/NM	5,07 USGal/h	,65 USGal/NM	115 NM	
3000	8,1 Nds	24,4 l/h	3,03 L/NM	6,45 USGal/h	,80 USGal/NM	94 NM	
3500	9,4 Nds	33,6 l/h	3,59 L/NM	8,88 USGal/h	,95 USGal/NM	79 NM	
4000	12,2 Nds	46,2 l/h	3,79 L/NM	12,20 USGal/h	1,00 USGal/NM	75 NM	
4500	24,3 Nds	54,2 l/h	2,23 L/NM	14,32 USGal/h	,59 USGal/NM	128 NM	
5000	27,9 Nds	70,7 l/h	2,54 L/NM	18,68 USGal/h	,67 USGal/NM	112 NM	
5500	31,4 Nds	88,3 l/h	2,81 L/NM	23,33 USGal/h	,74 USGal/NM	101 NM	
6000	33,2 Nds	94,0 l/h	2,83 L/NM	24,83 USGal/h	,75 USGal/NM	101 NM	
<u>Conditions optimales théoriques et purement indicatives des essais: /Optimal theoretical conditions, purely indicative for trials :</u>							
Coque neuve, vent 5nds, mer belle petit clapot, pas d'antifouling / new hull, wind 5 knots, nice little choppy sea, no antifouling							
03/06/2020							

RÉGIMES - VITESSES - CONSOMMATION / RPM - SPEED - CONSUMPTION

Merry Fisher 795 serie 2							
		YAMAHA 250cv					
		Caractéristique / Specifications:					
		2 moteur Hors Bord / Out Board engines:		F 250DETX / XCB DBW			
		Hélice / Propeller:		T15 SALTWATER			
Déplacement total du bateau / Total displacement of boat tested: 3422 Kg							
Regime en tours par minute au tableau de bord / RPM on instrument panel	Vitesse en nœuds moyenne au gps / Average speed on gps in knots	Consommation moteur en litres par heure / consumption engine in liter an hour	Rendement / Efficiency (L/NM = Liter per Nautical Mile)	Consommation totale en USGal / heure Total consumption in USGal/h	Rendement / Efficiency (USGal/NM)	Autonomie en miles nautiques (avec réserve 20%) /Range in Nautical Miles (with 20% fuel safety)	Remarques / Comments
600	2,2 Nds	2,2 l/h	1,02 L/NM	,58 USGal/h	,27 USGal/NM	279 NM	
1000	3,6 Nds	4,8 l/h	1,33 L/NM	1,27 USGal/h	,35 USGal/NM	214 NM	
1500	5,8 Nds	8,0 l/h	1,38 L/NM	2,11 USGal/h	,36 USGal/NM	207 NM	
2000	7,2 Nds	12,7 l/h	1,78 L/NM	3,35 USGal/h	,47 USGal/NM	160 NM	
2500	8,8 Nds	20,6 l/h	2,34 L/NM	5,44 USGal/h	,62 USGal/NM	122 NM	
3000	9,9 Nds	26,6 l/h	2,70 L/NM	7,03 USGal/h	,71 USGal/NM	106 NM	
3500	12,5 Nds	35,3 l/h	2,84 L/NM	9,33 USGal/h	,75 USGal/NM	101 NM	
4000	22,4 Nds	46,8 l/h	2,09 L/NM	12,36 USGal/h	,55 USGal/NM	136 NM	
4500	27,1 Nds	65,4 l/h	2,41 L/NM	17,28 USGal/h	,64 USGal/NM	118 NM	
5000	30,1 Nds	91,7 l/h	3,05 L/NM	24,22 USGal/h	,81 USGal/NM	93 NM	
5500	33,8 Nds	96,0 l/h	2,84 L/NM	25,36 USGal/h	,75 USGal/NM	100 NM	
6000	34,3 Nds	97,0 l/h	2,83 L/NM	25,62 USGal/h	,75 USGal/NM	101 NM	
<u>Conditions optimales théoriques et purement indicatives des essais : /Optimal theoretical conditions, purely indicative for trials :</u>							
Coque neuve, vent 5nds, mer belle petit clapot, pas d'antifouling / new hull, wind 5 knots, nice little choppy sea, no antifouling							
03/06/2020							

HEIGHT OF OUTBOARD ENGINES SHAFTS / LONGUEURS ARBRES MOTEURS

Modèle	Motorisation	Pied d'embase / Shaft length	Longueur en mm / Length in mm	Longueur en pouces / Length in inches	YAMAHA	MERCURY	HONDA	SUZUKI
MERRY FISHER 795 Serie² / 795 Sport Serie²	mono / single	EXTRA LONG	635	25"	TX	XL	X	X

MODELES MODELS	ATTESTATION N° / CERTIFICATE N°	LONGUEUR COQUE* / HULL LENGTH*	LARGEUR COQUE* / HULL BEAM*	CHARGE MAX / MAX LOAD	CATEGORIE / CATEGORY	PERSONNES / PERSONS	PUISSANCE / MAXI POWER		MASSE MAXI MOTEUR / MAX ENGINE WEIGHT
							Kw	CV / HP	Kg
CAP CAMARAT		Mètres / Meters	Mètres / Meters	Kg			Kw	CV / HP	Kg
Merry Fisher 795 Serie 2	B SPB 20033 MM	6,97	2,79	1796	C	9	200	250	330
Merry Fisher 795 Sport Serie 2	B SPB 21057 MM			1930	C	9			

Pour les homologations en cours, toutes les informations doivent être considérées comme provisoires.

Les catégories et nombre de personnes indiqués correspondent à la demande faite par le chantier, pas à une confirmation.

When the EC regulation is in progress, please consider all information as provisional.

The categories and number of persons written are requested by the Jeanneau Yard, not confirmed.

* Indiqué sur la DEC (Déclaration Ecrite de Conformité)

* *Written on the WSC (Written Statement of Compliance)*

ND: Non Disponible / No Data

KIT AMARRAGE - MOUILLAGE / MOORING - ANCHORING KITS

Bateaux / Boats	MOUILLAGE / ANCHORING						AMARRE / MOORING		PARE-BATTAGES / FENDERS		
	Code / Ref	Ancre / Anchor		Chaîne / Chain		Câblot / Line		Code / Ref	Désignation / Détail	Code / Ref	Désignation / Détail
Merry Fisher 795 Serie ² 795 Sport Serie ²	162303	12 kg	Plate / Flat	8 mm	18m	30m	14mm	043143	4 x D12 L8000	189031	4 x 645 x D.150

This is not a contractual document.
This document was updated in July 2024.
It may contain illustrations or text representing
or referring to optional equipment.
If changes appear on our 2025 models,
with regard to equipment or options referred to in this document,
only the current Jeanneau rate will apply.

